

BILATERAL SERVICE COLUMNS

P/N 0E39314

Bilateral service column ▶ suitable for 4 hose reels + 2 hose reels S. 260 mounted on the bottom side (see below picture)

No.1 packing m³ 0,77 kg 265

OVERALL DIMENSIONS P:600 H:2640 L:1290 mm

P/N 0E39317

Bilateral service column ▶ suitable for 6 hose reels + 2 hose reels S. 260 mounted on the bottom side (see below picture)

No.1 packing m³ 0,86 kg 305

OVERALL DIMENSIONS P:600 H:2640 L:1770 mm

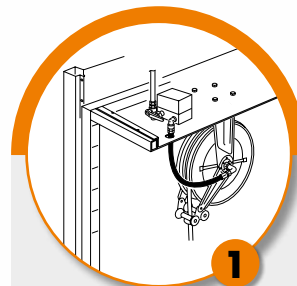

1
Universal drillings for application of accessories

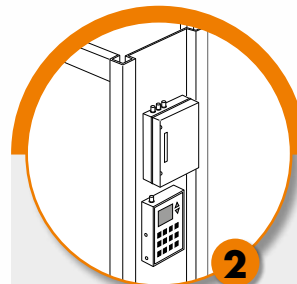

2
Suitable for the installation of the FCS system

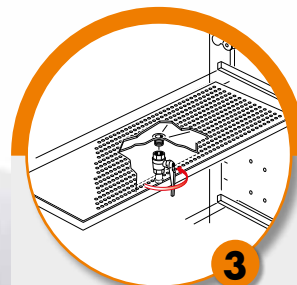

3
Drip-tray

CEILING INSTALLATION

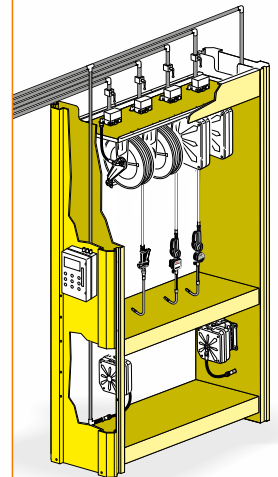

FLOOR INSTALLATION

